

PROFESSIONAL SERIES (PRO-Z 500S, 700S, 900S)

Date: February 02, 2021

Models Affected: PRO-Z 500S
PRO-Z 700S
PRO-Z 900S

Serial Number Range Affected: Units Manufactured March 01, 2016 through December 11, 2020.
(1C016Hxxxxx through 1L110Hxxxxx).

Subject: Optional Steering Shaft Flange Bushing

INFORMATIONAL ONLY

NOTE: These materials are prepared for use by trained technicians who are experienced in the service and repair of equipment of the kind described in this publication, and are not intended for use by untrained or inexperienced individuals. Such individuals should seek the assistance of an authorized service technician or dealer.

NOTE: Always wear eye protection while servicing equipment. Wear hearing protection when appropriate. Always work in a well ventilated area and follow all safety precautions when dealing with combustible materials.

NOTE: Left (LH) and Right (RH) sides are determined from the operator's position and facing in the forward direction.

PURPOSE:

We have received reports of a rattling noise from the steering column. This rattling noise occurs from the two (2) powdered metal flange bushings **948-0209** located in the upper steering column. This is not a mechanical failure and this issue does not occur on every unit manufactured.

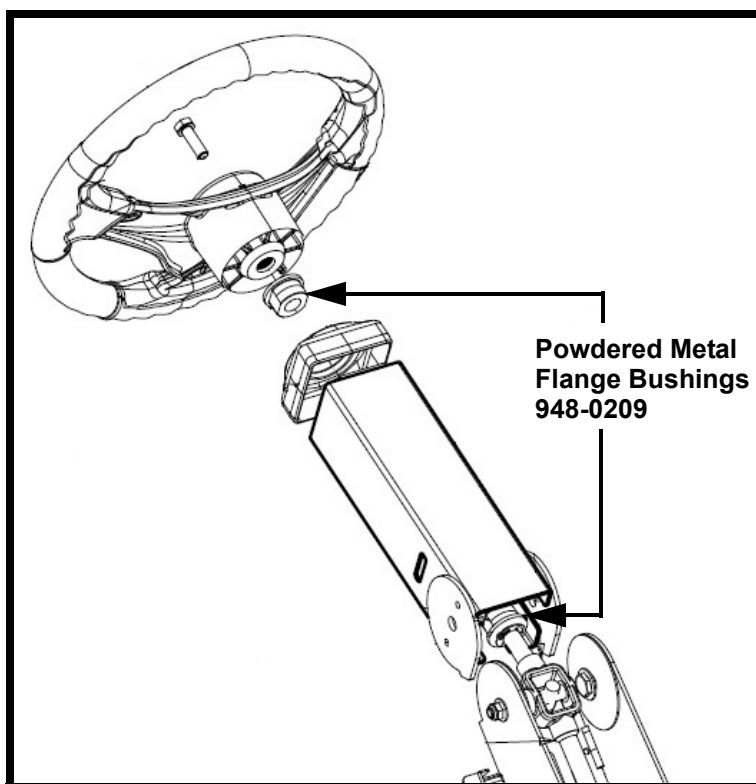

FIGURE 1

ACTION REQUIRED:

If your customer mentions or is annoyed about the rattling noise from the steering column, we now offer an optional flange bushing made of Delrin polymer material. This material is designed to replace metal components. It combines a low-friction and high wear resistance quality.

If the customer decides they would like the optional, Non-Warranty part installed, please follow the following steps.

1. Order from your normal parts source the following parts.

Qty. (2) **741-07090** Flange Bushing

Qty. (1) **710-0643** Hex Head Cap Screw Patch Lock 5/16-18 x 1.0"

2. Park the rider on a flat level surface. Engage the parking brake.

3. Disconnect the negative battery cable from the negative battery terminal.

4. Remove the center steering wheel cap.

5. Remove the 5/16-18 x 1.00 hex head cap screw with patch lock and the bell washer. Discard the cap screw.

6. Remove the steering wheel.

7. Remove the hex shoulder screw (**A**), flat washer (**B**) and 14-20 flange nut (**C**) from the tilt cylinder (**D**) at the upper column connection. Separate the tilt cylinder from the See Figure 2. Retain all hardware.

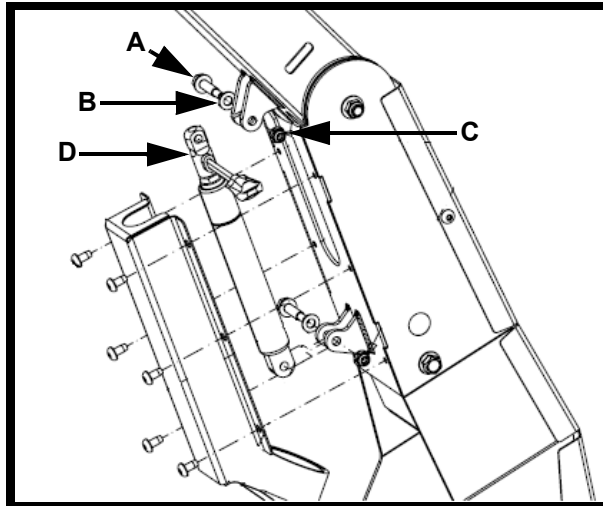

FIGURE 2

8. Remove the two (2) 3/8-16 nylon lock flange nuts (**E**). See Figure 3.

9. Remove the two (2) shoulder screws (**F**) and the two (2) flat washers (**G**) shown in Figure 3.

10. Remove the two (2) large black column plate washers (**H**). Retain all hardware removed in Steps 8 through 10.

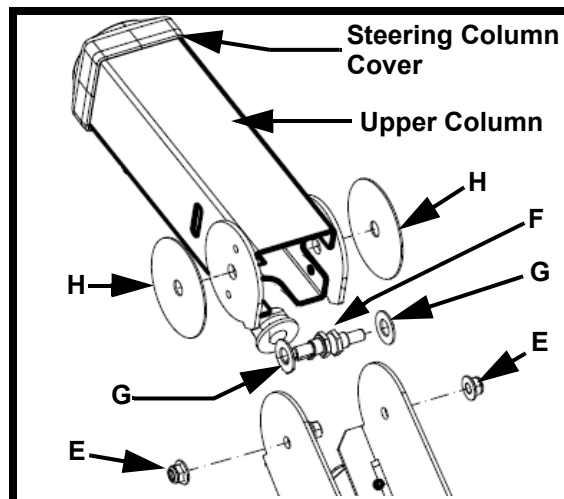

FIGURE 3

11. Remove the upper column upward off the upper steering shaft.

12. Remove the #10-16 x 1.25" screw that secures the steering column cover to the upper column. Remove the steering column cover. Retain hardware.

13. The powdered metal bushings have a slight press fit and will need to be knocked out with a drift punch. Discard the flange bushing after removal.

14. Install one (1) of the new **741-07090** Flange Bushings (I) into the upper column with the inner flange pointing upward. The flange bushing will have a slight press fit into the upper column. Use a soft face mallet to seat the flange bushing. Install the remaining **741-07090** Flange Bushing into the lower portion of the upper column using the soft face mallet. See Figure 4.

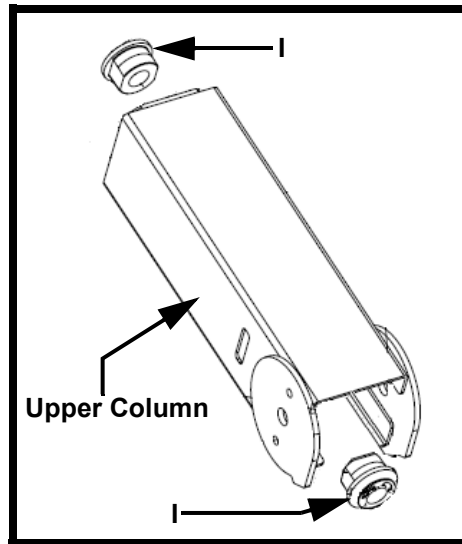

FIGURE 4

15. Repeat Steps 12 through 7 in reverse order.

16. Tighten the 3/8-16 nylon lock flange nuts (E) to 35 ft. lbs. Tighten the 14-20 flange nut (C) to 8-12 ft. lbs.

17. Orient the steering wheel in the forward position before installing, then install the bell washer.

18. Install the new **712-0643** Hex Head Cap Screw Patch Lock 5/16-18 x 1.0" to secure the steering wheel to the upper steering shaft. Torque to 13-20 ft. lbs.

19. Install the steering wheel cap.

20. Connect the negative battery cable to the negative battery terminal.

21. Confirm that all safety features of the rider are functioning properly before returning back into service.

THIS AREA LEFT INTENTIONALLY BLANK

This Advisory is being released for informational purposes only.

SERVICE MANAGER	PARTS MANAGER	SALES MANAGER	SERVICE TECH.	SERVICE TECH.

Circulate and Initial

DRM