

## PROFESSIONAL SERIES

Date: May 28, 2020 Revised February 23, 2022

Subject: Belt Guide Deck Stabilizer Bracket

**PRO Z 500**  
**Models Affected:** \*\*PRO Z 500 KW 554-L (53RIHJTN050, 53TIHJTN050).  
\*\*PRO Z 500 EFI 554-L (53RWHJTN050).  
PRO Z 500 KW 554-S (53RIHJUN050, 53TIHJUN050).  
\*\*PRO Z 500 KW 560-L (53LIHJTV050, 53TIHJTV050).  
PRO Z 500 KW 560-S (53LIHJUV050, 53TIHJUV050).

**PRO Z 700**  
**Models Affected:** \*\*PRO Z 700 KW EFI 760-L (53RLHKT050).  
\*\*PRO Z 700 KW 760-L (53RIHKT050, 53TIHKT050).  
PRO Z 700 KW 760-S (53RIHKUV050, 53TIHKUV050).  
\*\*PRO Z 700 KW 772-L (53RIHKTY050, 53TIHKTY050).  
PRO Z 700 KW 772-S (53RIHKUY050).

**PRO Z 900**  
**Models Affected:** \*\*PRO Z 900 EFI 960-L (53REHMT050).  
\*\*PRO Z 900 KW 960-L (53RIHMT050, 53TIHMT050).  
PRO Z 900 EFI 960-S (53REHMUV050).  
PRO Z 500 KW 560-S (53RIHMUV050, 53TIHMUV050).  
\*\*PRO Z 900 KW 972-L (53RIHMTY050, 53TIHMTY050).  
PRO Z 900 KW 972-S (53RIHMUY050, 53FIHMUY050).  
PRO Z 900 KW 972-SD Dually (53TIHMUY050).  
PRO Z 900 KW 972-SDL Dually (53TILMUY050).

**NOTE: All Lap Bar Models with \*\* are affected by Issue #2.**

### Issue #1

**Serial Number** 54" & 60" Models Manufactured March 01, 2016 - May 28, 2020 (1C016Hxxxxx - 1E280Hxxxxx).  
**Range Affected:** 72" Models Manufactured March 01, 2016 - February 29, 2020 (1C016Hxxxxx- 1B290Hxxxxx).

### Issue #2

**Serial Number** 54" & 60" Models Manufactured March 01, 2016 - February 15, 2022 (1C016Hxxxxx - 1B22NHxxxxx).  
**Range Affected:** 72" Models Manufactured March 01, 2016 - February 15, 2022 (1C016Hxxxxx- 1B22NHxxxxx).

**PURPOSE:** This Revised Service Kit **759-05902A** covers two issues.

**Issue #1:** Was on older units where the deck stabilizer bracket was failing under normal conditions on the 54", 60" and 72" mower decks on the above listed Models. **NOTE: This issue was addressed with the 759-05902 Service Kit released May 28, 2020.**

**\*\*Issue #2:** Is from recent reports of the dampers of the lap bars interfering with the previous style Deck Stabilizer Bracket (**703-24927A**) and the idler spring anchor bolt with spacer on the back side of the deck that was previously included in the **753-05902** Service Kit. We have revised the Service Kit **759-05902A** with a new deck stabilizer bracket and a shorter shoulder bolt to address both issues.

**NOTE: If a Lap Bar Model that previously had the Service Kit 759-05902 installed, its recommended to install the new Deck Stabilizer Bracket and shorter shoulder bolt contained in the 759-05902A Service Kit. The existing hardware or the new hardware contained in the Service Kit may be used for the installation.**

**NOTE: These materials are prepared for use by trained technicians who are experienced in the service and repair of equipment of the kind described in this publication, and are not intended for use by untrained or inexperienced individuals. Such individuals should seek the assistance of an authorized service technician or dealer.**

**NOTE: Always wear eye protection while servicing equipment. Wear hearing protection when appropriate. Always work in a well ventilated area and follow all safety precautions when dealing with combustible materials.**

**NOTE: Left (LH) and Right (RH) sides are determined from the operator's position and facing in the forward direction.**

A list of the Service Kit contents are listed at the top of Page 2.

For **72"** Mower Deck repair follow the instructions Steps 1 through 18 for the **Deck Stabilizer Bracket Installation**, then Steps 33 through 35 for **Spring Anchor Installation for the PTO Idler Bracket**. For riders that utilized the **680-00453 Rear Roller Stabilizer Bracket** follow Steps 36 through 50.

For **54"** and **60"** mower deck repair follow the instructions Steps 19 through 32 for the **Deck Stabilizer Bracket Installation**, then Steps 33 through 35 for **Spring Anchor Installation for the PTO Idler Bracket**. For riders that utilized the **680-00453 Rear Roller Stabilizer Bracket** follow Steps 36 through 50.

# 759-05902A Service Kit Contents

ITEM NO.	PART NUMBER	QTY	DESCRIPTION
1	703-27884A**	1	BRKT:DECK STAB:BELT GUIDE
2	703-23064**	1	MT:BRKT:REAR ROLLER RH
3	710-3261	2	HEX SCREW
4	710-0932A	2	BOLT:CARRIAGE:1/4-20X1.0"
5	710-0859	1	SCREW:HEX:3/8-16X2.5
6*	710-3168	1	BOLT:CARRIAGE:3/8-16X1.0LG GR5
7	712-3008	2	NUT:HEX JAM:3/8-16
8	712-04064	2	NUT:FLANGE LK NYLON:1/4-20 GRF
9	712-04065	3	NUT: FLANGE LK NYLON:3/8-16 GRF
10	712-04217	1	NUT:FLANGE LK:3/8-16 TOPLK
11	736-3052	1	WASHER:FLAT:0.401X1.011X0.120
12	736-3039	1	WASHER:FLAT:0.401X1.510X0.113
13	736-0300	1	WASHER:FLAT:0.396X0.885X0.060
14	738-0145	1	SCREW:SHLDR:0.500X0.820X3/8-16
15	750-05673	1	SPACER

\* Used On 54" & 60" Decks Only

\*\* Use Paint Code -4021

Instruction sheet included with kit.

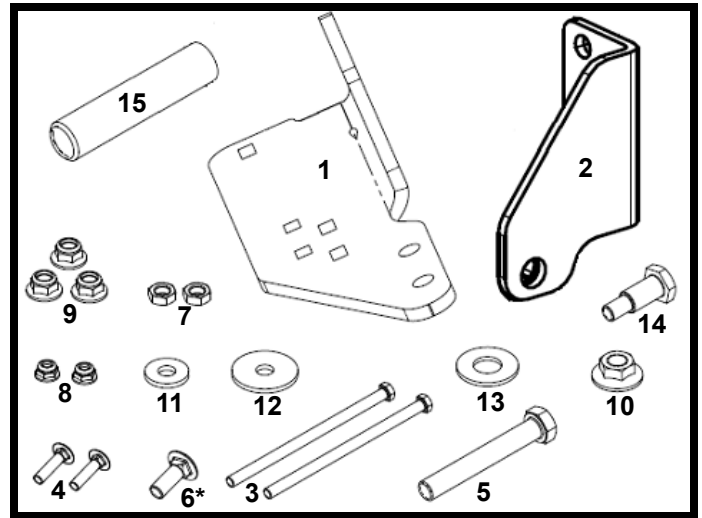

FIGURE 1

## 72" Mower Deck Stabilizer Bracket Installation: (Complete For Issue #1 and #2)

1. Park the rider on a flat level surface. Engage the parking brake.
2. Lower the mower deck to the lowest position and remove the mower deck from under the rider.
3. Remove the stabilizer tube from the stabilizer bracket then remove the stabilizer bracket from the mower deck. Retain the mounting hardware from the stabilizer bracket.
4. Remove the pin stud from the original stabilizer bracket, retain the pin, nut and stabilizer tube.
5. Locate from the Service Kit Item #1 (703-27884A) Belt Guide Deck Stabilizer Bracket. For a 54" & 60" Mower Deck proceed to Step 19 on Page 3.
6. Install the pin removed in Step 4 and install on to the Belt Guide Deck Stabilizer Bracket and secure with the nut removed in Step 4. See Figure 2.
7. Place the Belt Guide Deck Stabilizer Bracket on top of the deck housing and align the inner hole pattern in the bracket over the existing holes in the deck housing as shown in Figure 2.

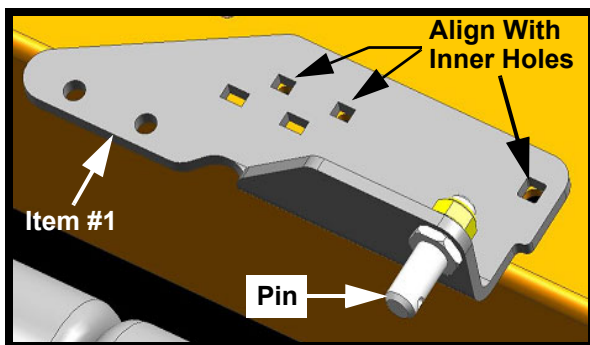

FIGURE 2

8. Locate the two (2) Item #4 (710-0932A) 1/4-20 x 1.0" Carriage Bolts and two (2) Item #8 (712-04064) 1/4-20 Nylon Lock Flange Nuts.
9. Install them as shown through the bracket and deck housing in Figure 3.

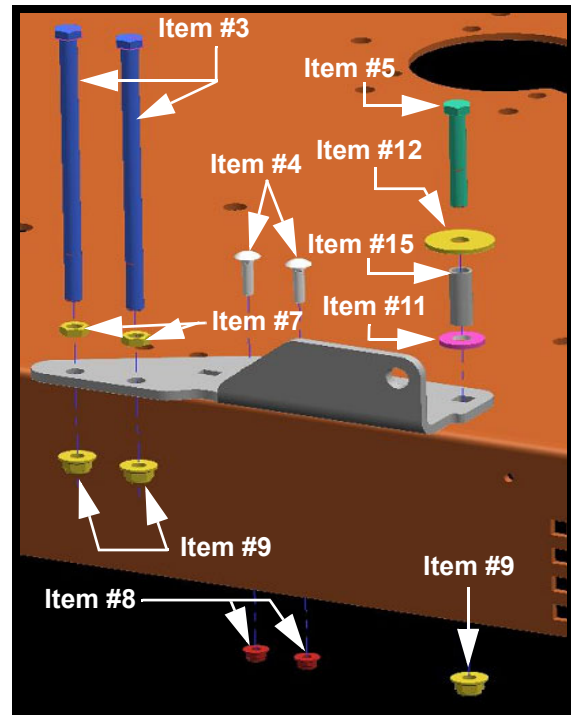
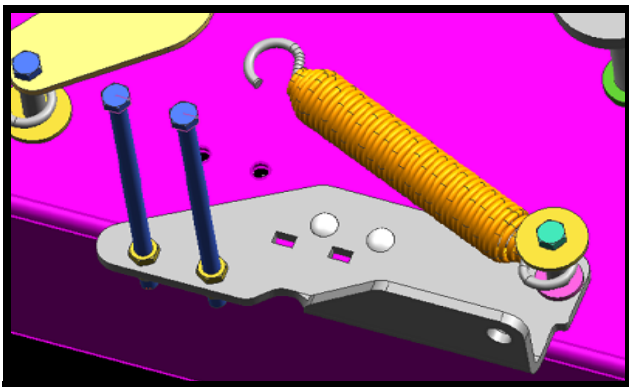

FIGURE 3

10. Locate the following Items from the Service Kit. Item #5 (710-0859) 3/8-16 X 2.5 Hex Screw, Item #12 (736-3039) Flat Washer, Item #15 (750-05673) Spacer, Item #11 (736-3052) Flat Washer and one (1) of Item #9 (712-04065) 3/8-16 Nylon Lock Flange Nut.

11. Assemble all the items from Step 10 as shown in Figure 3.
12. Tighten both Item #8's to a torque of 15 ft. lbs. (180 in. lbs.).
13. Tighten Item #9 to a torque of 35 ft. lbs. (420 in. lbs.).
14. Locate from the Service Kit two (2) of Item #3 (710-3261) 3/8-16 x 7.0 Hex Head Cap Screw.
15. Locate two (2) of Item #7 (712-3008) 3/8-16 Hex Jam Nut and two (2) of Item #9 (712-04065) 3/8-16 Nylon Lock Flange Nut.
16. Assemble the Items from Step 14 & 15 as shown in Figure 3. **NOTE: Thread the 3/8-16 Hex Jam Nut all the way to the end of the threads of the 3/8-16 x 7.0 Hex Head Cap Screw.**
17. Tighten both Item #9's to a torque of 35 ft. lbs. (420 in. lbs.).
18. Figure 4 shows the installed bracket. Proceed to Step 40 for Stabilizer Tube rework and Bracket installation.



**FIGURE 4**

**54" & 60" Deck Stabilizer Bracket Installation:  
(Complete For Issue #1 and #2)**

19. Locate from the Service Kit Item #1 (703-27884A) Belt Guide Deck Stabilizer Bracket.
20. Install the pin removed in Step 4 and install on to the Belt Guide Deck Stabilizer Bracket and secure with the nut removed in Step 4.
21. Place the Belt Guide Deck Stabilizer Bracket on top of the deck housing and align the inner hole pattern in the bracket over the existing holes in the deck housing as shown in Figure 8.
22. If needed, use the bracket as a template to mark the position of the hole that needs to be drilled in the deck housings top plate. See Figure 8. if not proceed to Step 24.
23. If needed use a 25/64" drill bit to drill the hole. Use a round file to clean up any burrs left from the drilling process.

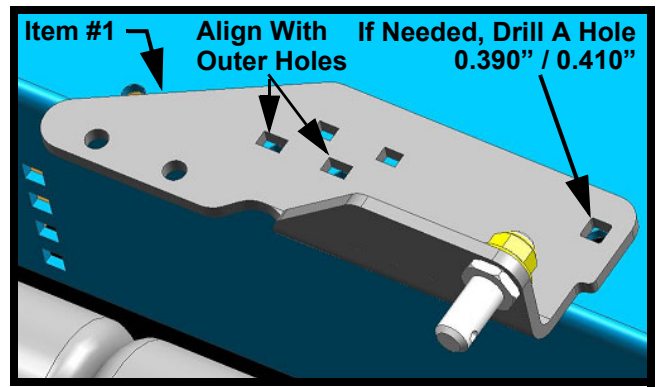

**FIGURE 8**

24. Locate the two (2) Item #4 (710-0932A) 1/4-20 x 1.0" Carriage Bolts and two (2) Item #8 (712-04064) 1/4-20 Nylon Lock Flange Nuts.
25. Locate Item #6\* (710-3168) 3/8-16 x1.0" Carriage Bolt an Item #9 (712-04065) 3/8-16 Nylon Lock Flange Nut.
26. Install them as shown through the bracket and deck housing in the two outer holes Figure 9.

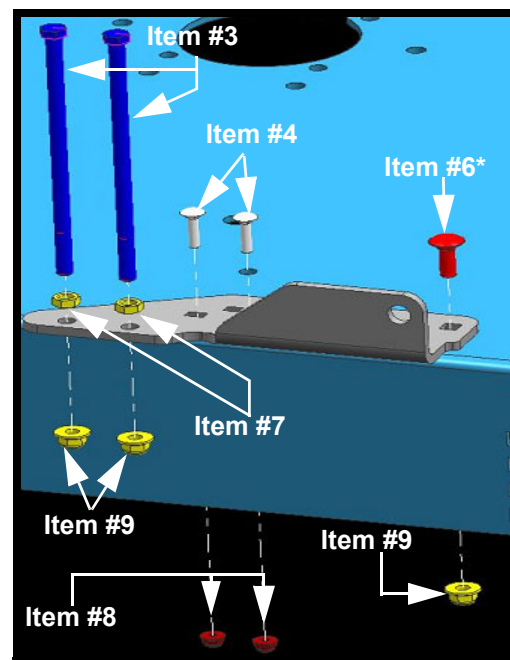
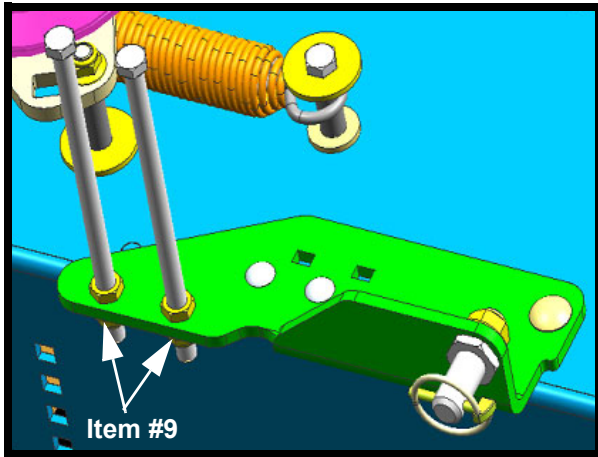

**FIGURE 9**

27. Tighten Item #9 to a torque of 35 ft. lbs. (420 in. lbs.).
28. Tighten Item #8 to a torque of 35 ft. lbs. (420 in. lbs.).
29. Locate from the Service Kit two (2) of Item #3 (710-3261) 3/8-16 x 7.0 Hex Head Cap Screw.
30. Locate two (2) of Item #7 (712-3008) 3/8-16 Hex Jam Nut and two (2) of Item #9 (712-04065) 3/8-16 Nylon Lock Flange Nut.

31. Assemble the Items from Step 29 & 30 as shown in Figure 9. **NOTE: Thread the 3/8-16 Hex Jam Nut all the way to the end of the threads of the 3/8-16 x 7.0 Hex Head Cap Screw.**

32. Tighten both Item #7's to a torque of 15 ft. lbs. (180 in. lbs). Tighten both Item #9's to a torque of 35 ft. lbs. (420 in. lbs.). Figure 10 shows the installed bracket.



**FIGURE 10**

**54", 60" and 72" Spring Anchor Installation for the PTO Idler Bracket: (Complete For Issues #1 and #2)**

33. Locate from the Service Kit Item #14 (738-0145) Shoulder Screw, Item #13 (736-0300) Flat Washer and Item #10 (712-04217) 3/8-16 Top Lock Flange Nut. See Figure 11.

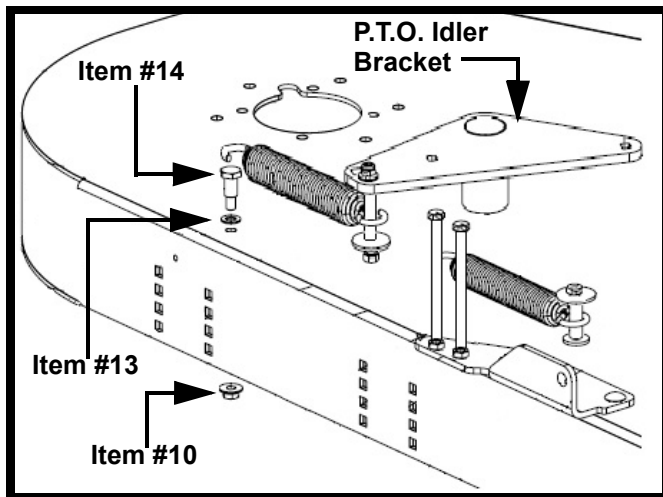

**FIGURE 11**

34. Assemble the Items from Step 33 as shown in Figure 11. Tighten item #13 to 21-32 ft. Lbs. **NOTE: The shoulder bolt, (Item #14) is the anchor point for the P.T.O. Idler Bracket extension spring. Figure 11 represents A 60" Mower setup.**

35. For units that have the 680-00453 Rear Roller Stabilizer Bracket proceed to Step 36, "Rear Roller RH Mounting Bracket Installation" For units that do not have the 680-00453 Rear Roller Stabilizer Bracket proceed to Step 49.

**Rear Roller RH Mounting Bracket Installation: (Complete For Issue #1)**

36. On riders that utilized the 680-00453 Rear Roller Stabilizer Bracket, locate Item #2 (703-23064) Rear Roller Bracket. **NOTE: The 680-00453 Rear Roller Stabilizer Bracket is a multi function piece that supported the rear roller assembly on the right side and was the right side connection point for the stabilizer tube.**

37. Position Item #2 as shown in Figure 12 to align with the holes in the deck housing and the roller assembly.

38. Secure in place with the hardware retained in Step 3.

39. Torque the two (2) 3/8-16 Nylon Lock Flange Nut to 35 ft. lbs. (420 in. lbs.). Torque the 1/2-13 Nylon Lock Flange Nut to 65 ft. lbs.

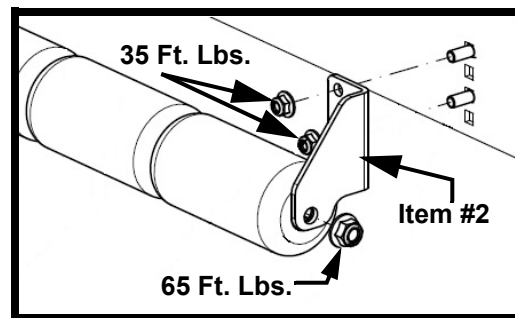

**FIGURE 12**

**Stabilizer Tube Rework: NOTE: This rework is required for all 54", 60" and 72" Mower Decks.**

40. Locate the stabilizer tube removed in Step 3.

41. Remove one (1) of the eye bolts and hex jam nuts from the end of the stabilizer tube.

42. The stabilizer tube needs to be shortened by 3/4". See Figure 13.

43. Cut 3/4" off the end of the tube. The the length after the cut should be a total length of 19.500" (19-1/2").

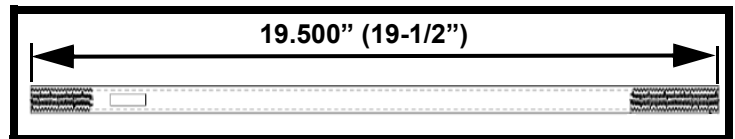

**FIGURE 13**

44. After cutting the stabilizer tube, reinstall the eye bolt and hex jam nut that was removed in Step 24.

45. Install the mower deck back under the rider and secure in place.

46. Raise the mower deck to a height of 3".

47. Adjust the length of the stabilizer tube by screwing the eye bolts in or out until the eye bolts slip on the pins. You should not have to move the deck to one side or the other to install the eye bolts. See Figure 13.

48. Once the stabilizer tube is in place tighten the jam nuts on both off the eye bolts. Figure 14 shows the completed repair for the 54" and 60" Models. Figure 15 shows the complete repair for the 72" Models. **NOTE: It may be easier to tighten the jam nut on one end before installing in place.**

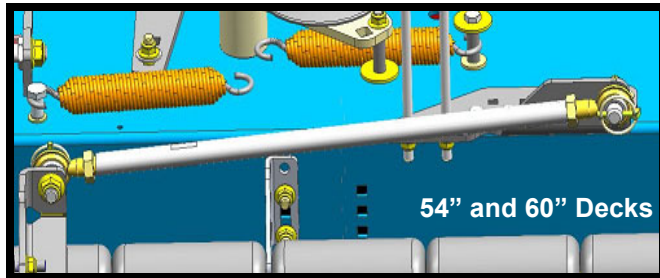

**FIGURE 14**

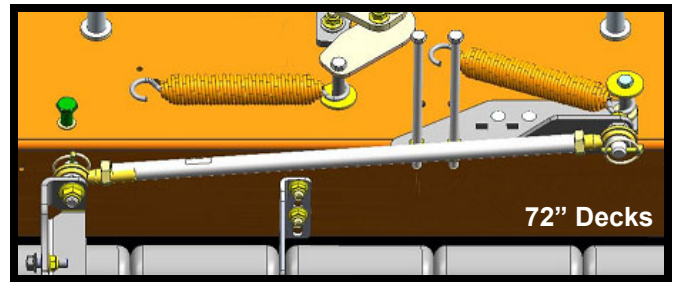

**FIGURE 15**

49. Start the rider and confirm that all safety features are operating correctly.

50. In a clear area free of people and hazards test drive the rider prior to returning to service.

THIS AREA LEFT INTENTIONALLY BLANK