

Power Equipment

Code: CC-277

Date: 26 April, 94

Subject: Front wheels rubbing the side panels while turning on slopes or hills.

Models: 2160, 2165 and 2185.

Problem: Incorrect tolerances in the steering geometry.

Solution: Order the parts listed and install following the instructions provided.

<u>PART #</u>	<u>REF. #</u>	<u>QTY.</u>	<u>NAME</u>
750-0703	1	2	SPACER
736-0315	2	2	WASHER

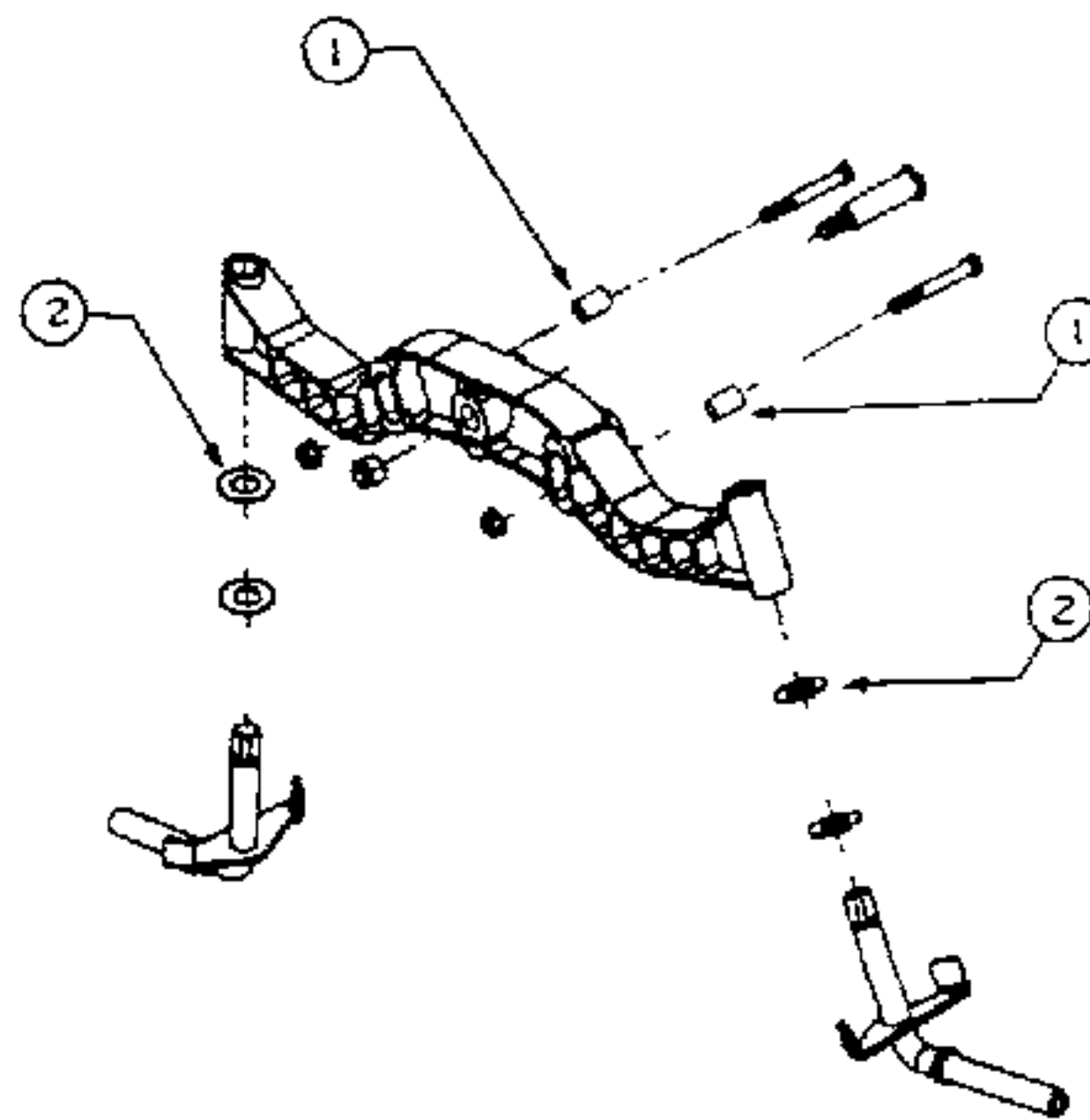

Instructions: Check for the proper 1/8th inch toe-in from rim to rim at the front of the tractor. Install the spacers (reference number 1) over the limiter bolts for the front pivot axle as shown. Install one flat washer (reference number 2) between each steering knuckle and the pivot axle. NOTE : DO NOT REMOVE EXISTING WASHERS FROM THE STEERING KNUCKLES. The total thickness of both washers raises the front of the tractor to allow proper clearance. Submit a warranty claim for 1 hr labor and the cost of the parts.

Circulate and initial

Service Mgr	Parts Mgr	Service Tech.	Service Tech.	
-------------	-----------	---------------	---------------	--